

Serie 16000

16000 Series



ASSA ABLOY, the global leader
in door opening solutions



Incontri elettrici Serie 16000: FUNZIONE A

16000 Series door releases: A FUNCTION

FUNZIONE A

Con slitta antiripetitore:

sganciamento permanente dopo l'impulso elettrico. La chiusura viene ripristinata dopo che la porta è stata aperta e chiusa

Con leva fermo a giorno

Caratteristiche tecniche:

- Scrocco regolabile fino a 5 mm.
- Reversibile
- Corpo di dimensioni ridotte per ogni impiego
- La slitta fatta a cuneo (antiripetitore) facilita lo sgancio dello scrocco serratura
- Alimentazione **corrente alternata e continua unificata**
- Lunga durata: 250.000 cicli
- Resistenza alla spinta sullo scrocco: 350 kg
- Assorbimento da 0.5 a 0.8 A
- Alimentazione 6 - 12 V AC - DC o 24 V AC - DC
- Per serrature con interasse 72 - 85 - 92 mm.
- Abbinabile a frontali in acciaio inox satinato

A FUNCTION

With permanent release:



lock is permanently released upon electrical contact. Locking function is restored upon the door being opened and closed again

With hold open lever

Features:

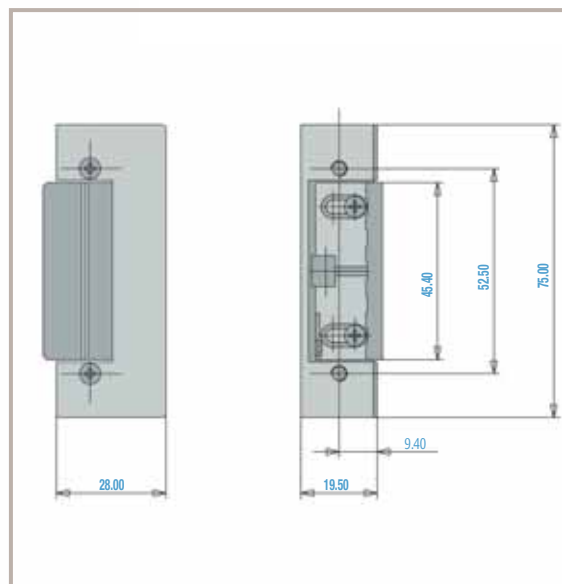
- **Fafix (5 mm.)**
- **Reversible**
- **Low core dimension for all use**
- Slide, **made a wedge (permanent release), make easy latch bolt released**
- Power supply **unified version alternate current and direct current**
- **Long life span 250.000 cycles**
- **Pressure resistant on the latch bolt 350 Kg**
- **Input from 0.5 to 0.8 A.**
- **Power supply 6 - 12 V AC - DC or 24 V AC - DC**
- **For locks 72 - 85 and 92 mm. distance**
- **Available with front plate in brush-polished stainless steel**



Codice / Code	Alimentazione Power Supply		
SOLO CORPO - CORE ONLY			
16160/1	6 - 12 V AC - DC	182	12
16160/8	24 V AC - DC	178	12

CORREDATO DI FRONTALE
 alimentazione 6-12 v ac-dc (per 24 v solo corpo + frontale a parte)
WITH FRONT PLATE
 power supply 6-12 v ac-dc (for 24 v core only and front plate separately)

		Codice / Code	Finitura / Finish			
Per serrature da fascia For midrail locks		Frontale ad U per profili porta - U Front plate for door profile				
		16100U/1	Inox	260	12	
		Frontale piatto per profili giunto aperto - Open joint door profile				
		16100P/1	Inox	268	12	
Per serrature da montante PUNTO For narrow style locks PUNTO		Frontale ad U per profili porta - U Front plate for door profile				
		Dx - Rhs 16200U/1D	Inox	280	12	
		Sx - Lhs 16200U/1S	Inox	280	12	
		Frontale piatto per profili giunto aperto - Open joint door profile				
		16200P/1	Inox	304	12	
Per serrature per porte in legno For mortise locks for timber doors		Frontale piatto - Front plate				
		16200Y/1	Inox	306	12	
		Frontale angolare - Corner front plate				
		Dx - Rhs 16200L/1D	Bronzo / Bronze	366	12	
		Sx - Lhs 16200L/1S	Bronzo / Bronze	366	12	
Per ARTIGLIO For ARTIGLIO		Frontale ad U per profili porta - U Front plate for door profile				
		Dx - Rhs 16119U/1D	Inox	298	12	
		Sx - Lhs 16119U/1S	Inox	298	12	
		Frontale piatto per profili giunto aperto - Open joint door profile				
		16119P/1	Inox	298	12	
Per SIMPLY CONTROL TREPPER		Frontale ad U per profili porta - U Front plate for door profile				
		Dx - Rhs 16219U/1D	Inox	274	12	
		Sx - Lhs 16219U/1S	Inox	274	12	
		Frontale piatto per profili giunto aperto - Open joint door profile				
		16219P/1	Inox	298	12	
Per AVANT e MINI AVANT		Frontale ad U per profili porta - U Front plate for door profile				
		Dx - Rhs 16240U/1D	Inox	280	12	
		Sx - Lhs 16240U/1S	Inox	280	12	
		Frontale piatto per profili giunto aperto - Open joint door profile				
		16240P/1	Inox	304	12	

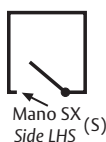

Incontri elettrici Serie 16000: FUNZIONE B

16000 Series door releases: B FUNCTION

FUNZIONE B

Con slitta antiripetitore:

Sganciamento permanente dopo l'impulso elettrico. La chiusura viene ripristinata dopo che la porta è stata aperta e chiusa
Senza leva fermo a giorno

Caratteristiche tecniche:

- Scrocco regolabile fino a 5 mm.
- Reversibile
- Corpo di dimensioni ridotte per ogni impiego
- La slitta fatta a cuneo (antiripetitore) facilita lo sgancio dello scrocco serratura
- Alimentazione **corrente alternata e continua unificata**
- Lunga durata: 250.000 cicli
- Resistenza alla spinta sullo scrocco: 350 kg
- Assorbimento da 0.5 a 0.8 A
- Alimentazione 6 - 12 V AC - DC o 24 V AC - DC
- Per serrature con interasse 72 - 85 - 92 mm.
- Abbinabile a frontali in acciaio inox satinato

B FUNCTION



With permanent release:

Lock is permanently released upon electrical contact. Locking function is restored upon the door being opened and closed again
Without hold open lever

Features:

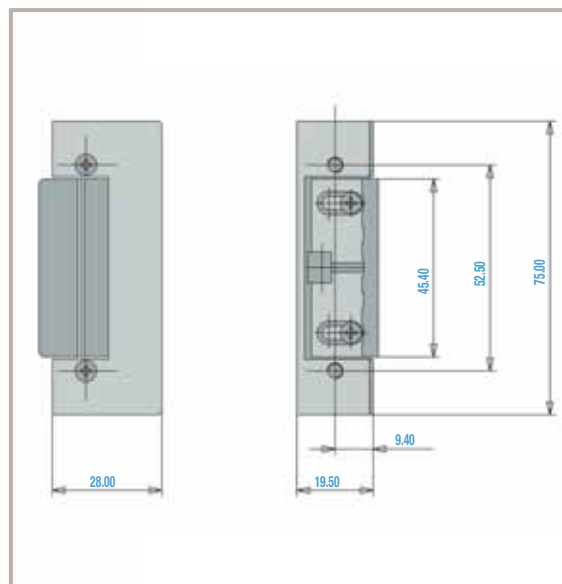
- *Fafix* (5 mm.)
- Reversible
- Low core dimension for all use
- Slide, made a wedge (permanent release), make easy latch bolt released
- Power supply **unified version alternate current and direct current**
- Long life span 250.000 cycles
- Pressure resistant on the latch bolt 350 Kg
- Input from 0.5 to 0.8 A.
- Power supply 6-12 V AC-DC or 24 V AC - DC
- For locks 72 - 85 and 92 mm distance
- Available with front plate in brush-polished stainless steel



Codice / Code	Alimentazione Power Supply		
SOLO CORPO - CORE ONLY			
16161/1	6 - 12 V AC-DC	180	12
16161/8	24 V AC-DC	178	12

CORREDATO DI FRONTALE
 alimentazione 6-12 v ac-dc (per 24 v solo corpo + frontale a parte)
WITH FRONT PLATE
 power supply 6-12 v ac -dc (for 24 v core only and front plate separately)

		Codice / Code	Finitura / Finish			
Per serrature da fascia For midrail locks		Frontale ad U per profili porta - U Front plate for door profile				
		16104U/1	Inox	262	12	
		Frontale piatto per profili giunto aperto - Open joint door profile				
		16104P/1	Inox	266	12	
Per serrature da montante PUNTO For narrow style locks PUNTO		Frontale ad U per profili porta - U Front plate for door profile				
		Dx - Rhs 16204U/1D	Inox	282	12	
	Sx - Lhs 16204U/1S	Inox	282	12		
		Frontale piatto per profili giunto aperto - Open joint door profile				
		16204P/1	Inox	304	12	
Per serrature per porte in legno For mortise locks for timber doors		Frontale piatto - Front plate				
		16204Y/1	Inox	300	12	
		Frontale angolare - Corner front plate				
		Dx - Rhs 16204L/1D	Bronzo/Bronze	364	12	
Sx - Lhs 16204L/1S	Bronzo/Bronze	364	12			
Per SIMPLY CONTROL TREPPER		Frontale ad U per profili porta - U Front plate for door profile				
		Dx - Rhs 16223U/1D	Inox	276	12	
	Sx - Lhs 16223U/1S	Inox	276	12		
		Frontale piatto per profili giunto aperto - Open joint door profile				
		16223P/1	Inox	296	12	
Per AVANT e MINI AVANT		Frontale ad U per profili porta - U Front plate for door profile				
		Dx - Rhs 16244U/1D	Inox	284	12	
	Sx - Lhs 16244U/1S	Inox	284	12		
		Frontale piatto per profili giunto aperto - Open joint door profile				
		16244P/1	Inox	298	12	



Incontri elettrici Serie 16000: FUNZIONE C

16000 Series door releases: C FUNCTION

FUNZIONE C

Senza slitta antiripetitore:

Sganciamento limitato al momento dell'impulso elettrico.
Finito l'impulso elettrico la chiusura si ripristina automaticamente

Con leva fermo a giorno

Caratteristiche tecniche:

- Scrocco regolabile fino a 5 mm.
- Reversibile
- Corpo di dimensioni ridotte per ogni impiego
- Alimentazione **corrente alternata e continua unificata**
- Lunga durata: 250.000 cicli
- Resistenza alla spinta sullo scrocco: 350 kg
- Assorbimento da 0.5 a 0.8 A
- Alimentazione 6 - 12 V AC - DC o 24 V AC - DC
- Per serrature con interasse 72 - 85 - 92 mm.
- Abbinabile a frontali in acciaio inox satinato

C FUNCTION

With limited release:



Lock is released only upon electrical contact.
Upon electrical contact being discontinued, locking function is automatically restored

With hold open lever



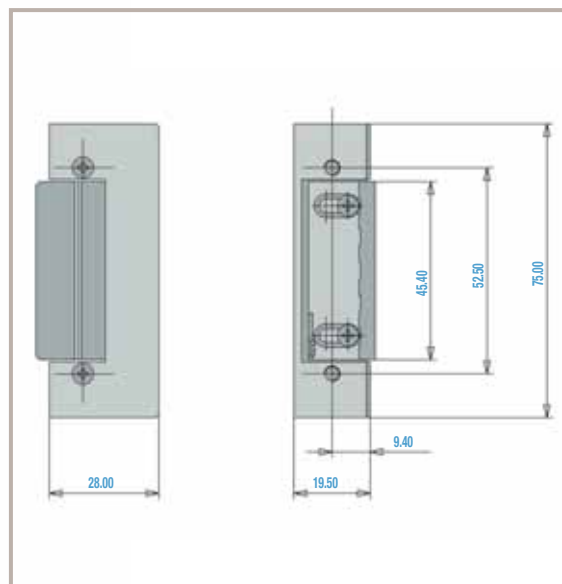









Features:

- **Fafix** (5 mm.)
- Reversible
- Low core dimension for all use
- Power supply **unified version alternate current and direct current**
- Long life span 250.000 cycles
- Pressure resistant on the latch bolt 350 Kg
- Input from 0.5 to 0.8 A.
- Power supply 6-12 V AC-DC or 24 V AC - DC
- For locks 72 - 85 and 92 mm. distance
- Available with front plate in brush-polished stainless steel



Codice / Code	Alimentazione Power Supply		
SOLO CORPO - CORE ONLY			
16162/1	6 - 12 V AC-DC	180	12
16162/8	24 V AC-DC	180	12

CORREDATO DI FRONTALE
alimentazione 6-12 v ac-dc (per 24 v solo corpo + frontale a parte)
WITH FRONT PLATE
power supply 6-12 v ac-dc (for 24 v core only and front plate separately)

		Codice / Code	Finitura / Finish		
Per serrature da fascia For midrail locks		Frontale ad U per profili porta - U Front plate for door profile			
		16110U/1	Inox	256	12
		Frontale piatto per profili giunto aperto - Open joint door profile			
		16110P/1	Inox	262	12
Per serrature da montante For narrow style locks		Dx - Rhs	Frontale ad U per profili porta - U Front plate for door profile		
		16210U/1D	Inox	280	12
	Sx - Lhs	16210U/1S	Inox	280	12
		Frontale piatto per profili giunto aperto - Open joint door profile			
		16210P/1	Inox	304	12
Per serrature per porte in legno For mortise locks for timber doors		Frontale piatto - Front plate			
		16210Y/1	Inox	300	12
		Dx - Rhs	Frontale angolare - Corner front plate		
16210L/1D		Bronzo/Bronze	362	12	
	Sx - Lhs	16210L/1S	Bronzo/Bronze	362	12
Per SIMPLY CONTROL TREPPER		Dx - Rhs	Frontale ad U per profili porta - U Front plate for door profile		
		16229U/1D	Inox	274	12
	Sx - Lhs	16229U/1S	Inox	274	12
		Frontale piatto per profili giunto aperto - Open joint door profile			
		16229P/1	Inox	294	12
Per AVANT e MINI AVANT		Dx - Rhs	Frontale ad U per profili porta - U Front plate for door profile		
		16250U/1D	Inox	286	12
	Sx - Lhs	16250U/1S	Inox	286	12
		Frontale piatto per profili giunto aperto - Open joint door profile			
		16250P/1	Inox	308	12



Incontri elettrici Serie 16000: FUNZIONE D

16000 Series door releases: D FUNCTION

FUNZIONE D

Senza slitta antiripetitore:

Sganciamento limitato al momento dell'impulso elettrico.
Finito l'impulso elettrico la chiusura si ripristina automaticamente

Senza leva fermo a giorno

Caratteristiche tecniche:

- Scrocco regolabile fino a 5 mm.
- Reversibile
- Corpo di dimensioni ridotte per ogni impiego
- Alimentazione **corrente alternata e continua unificata**
- **Lunga durata:** 250.000 cicli
- **Resistenza alla spinta** sullo scrocco: 350 kg
- Assorbimento da 0.5 a 0.8 A
- Alimentazione 6 - 12 V AC - DC o 24 V AC - DC
- Per serrature con interasse 72 - 85 - 92 mm.
- Abbinabile a **frontali in acciaio inox satinato**

D FUNCTION

With limited release:



Lock is released only upon electrical contact.
Upon electrical contact being discontinued, locking function is automatically restored

Without hold open lever



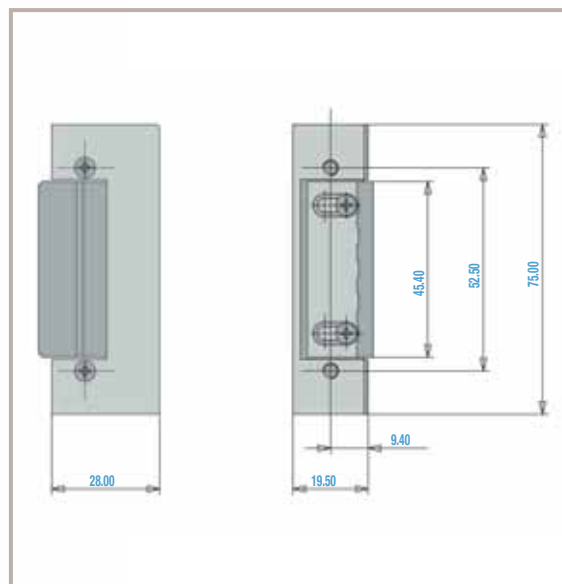







Features:

- **Fafix** (5 mm.)
- **Reversible**
- **Low core dimension for all use**
- Power supply **unified version alternate current and direct current**
- **Long life span** 250.000 cycles
- **Pressure resistant** on the latch bolt 350 Kg
- Input from 0.5 to 0.8 A.
- Power supply 6-12 V AC-DC or 24 V AC - DC
- For locks 72 - 85 and 92 mm. distance
- Available with **front plate in brush-polished stainless steel**

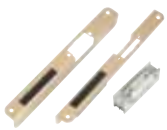

Codice / Code	Alimentazione Power Supply		
SOLO CORPO - CORE ONLY			
16163/1	6 - 12 V AC-DC	178	12
16163/8	24 V AC-DC	178	12

CORREDATO DI FRONTALE
 alimentazione 6-12 v ac-dc (per 24 v solo corpo + frontale a parte)
WITH FRONT PLATE
 power supply 6-12 v ac-dc (for 24 v core only and front plate separately)

		Codice / Code	Finitura / Finish			
Per serrature da fascia For midrail locks		Frontale ad U per profili porta - U Front plate for door profile				
		16114U/1	Inox	256	12	
		Frontale piatto per profili giunto aperto - Open joint door profile				
		16114P/1	Inox	264	12	
Per serrature da montante PUNTO For narrow style locks PUNTO		Frontale ad U per profili porta - U Front plate for door profile				
		Dx - Rhs	16214U/1D	Inox	280	12
		Sx - Lhs	16214U/1S	Inox	280	12
		Frontale piatto per profili giunto aperto - Open joint door profile				
		16214P/1	Inox	306	12	
Per serrature per porte in legno For mortise locks for timber doors		Frontale piatto - Front plate				
			16214Y/1	Inox	300	12
			Frontale angolare - Corner front plate			
Dx - Rhs	16214L/1D		Bronzo / Bronze	366	12	
	Sx - Lhs	16214L/1S	Bronzo / Bronze	366	12	
Per SIMPLY CONTROL TREPPER		Frontale ad U per profili porta - U Front plate for door profile				
		Dx - Rhs	16233U/1D	Inox	294	12
		Sx - Lhs	16233U/1S	Inox	294	12
For SIMPLY CONTROL TREPPER		Frontale piatto per profili giunto aperto - Open joint door profile				
		16233P/1	Inox	294	12	
Per AVANT e MINI AVANT		Frontale ad U per profili porta - U Front plate for door profile				
		Dx - Rhs	16254U/1D	Inox	286	12
		Sx - Lhs	16254U/1S	Inox	286	12
For AVANT and MINI AVANT		Frontale piatto per profili giunto aperto - Open joint door profile				
		16254P/1	Inox	286	12	

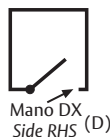

Incontri elettrici Serie 16000 ad interruzione di corrente: Funzione E

16000 Series fail safe door release: E Function

FUNZIONE E

Ad interruzione di corrente: in caso di black out la porta resta aperta. Per uso pubblico
Senza leva fermo a giorno

Caratteristiche tecniche:

- Scrocco regolabile fino a 5 mm.
- Reversibile
- **Corpo di dimensioni ridotte** per ogni impiego
- Alimentazione **corrente alternata e continua unificata**
- **Lunga durata:** 250.000 cicli
- **Resistenza alla spinta** sullo scrocco: 350 kg
- Assorbimento 0.15 - 0.28 A
- Alimentazione 12-24 V DC
- Per serrature con interasse 72, 85, 92 mm.
- Abbinabile a **frontali in acciaio inox satinato**



FUNCTION E

Fail safe: during a Black-Out the electric striker released the door. For public use
Without hold-open lever

Features:

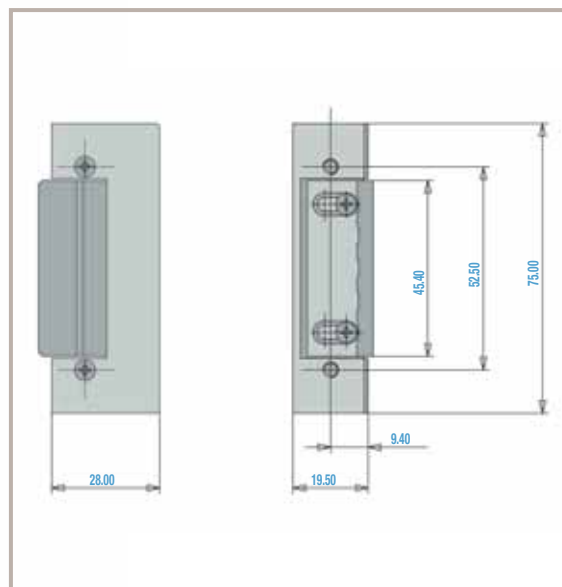
- **Fafix** (5 mm.)
- **Reversible**
- **Low core dimension** for all use
- Power supply **unified version alternate current and direct current**
- **Long life span** 250.000 cycles
- **Pressure resistant** on the latch bolt 350 Kg
- Input 0.15 - 0.28 A
- Power supply 12-24 V DC
- For locks 72, 85 and 92 mm distance
- Available with **front plate in brush-polished stainless steel**



Codice / Code	Alimentazione Power Supply		
SOLO CORPO - CORE ONLY			
16173/2	6 / 12 V DC	182	12
16173/8	24 V DC	178	12

Articolo utilizzabile con tutti i frontali presenti nella sezione accessori
Available with all front plate present in accessories

Frontali

Front plates

Per serrature da fascia
Profili porta
For midrail locks
Door profile

Frontale corto a
U in inox
Short U-rail front plate
in stainless steel

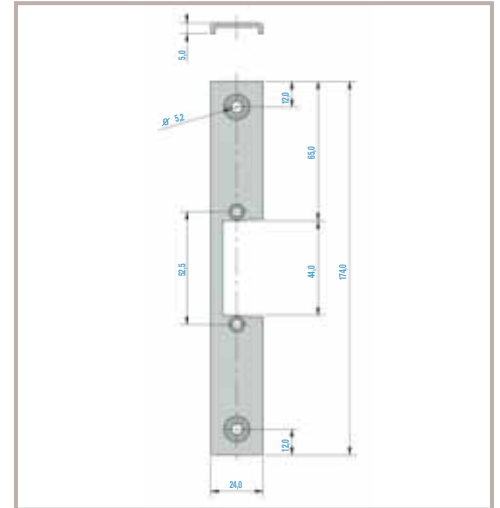

Codice / Code

Mano / Side



Con tappi - With caps

16180

Reversibile / Reversible

74

12

Per serrature da fascia
Profili giunto aperto
For midrail locks
Open joint door profile

Frontale corto
piatto in inox
Short flat front plate in
stainless steel

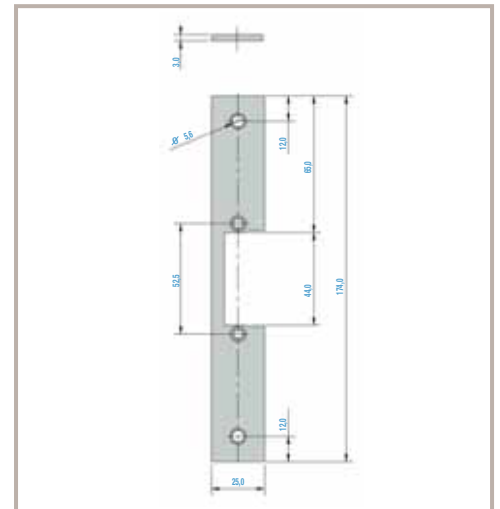

Codice / Code

Mano / Side



16182

Reversibile / Reversible

84

12

Per serrature da montante e PUNTO
Profili porta
For narrow style locks and PUNTO
Door profile

Frontale lungo a
U in inox
Long U - rail front plate
in stainless steel

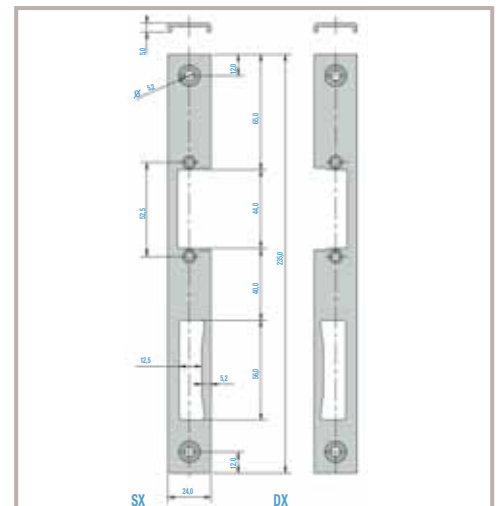

Codice / Code

Mano / Side



Con tappi e vaschetta - With caps and cup

16184/D

Dx / Rhs

94

12

16184/S

Sx / Lhs

94

12

Frontali

Front plates

Per serrature da montante e PUNTO
 Profili giunto aperto
 For narrow style locks and PUNTO
 Open joint door profile

Frontale lungo piatto
 in inox
 Long flat front plate in
 stainless steel

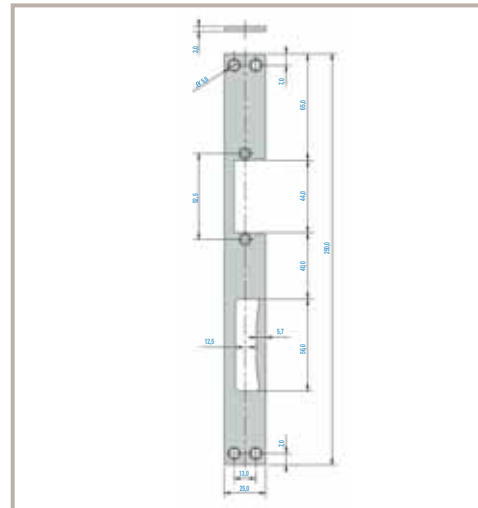

Codice / Code	Mano / Side		
Con vaschetta - With cup			
16185	Reversibile / Reversible	112	12

Simply Control Trepper
 Profili porta
 Door profile

Frontale lungo a
 U in inox
 Long U - rail front plate
 in stainless steel

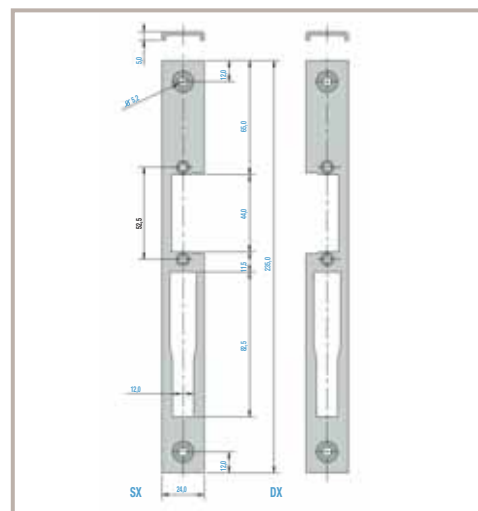

Codice / Code	Mano / Side		
Con tappi e vaschetta - With caps and cup			
16177/D	Dx / Rhs	88	12
16177/S	Sx / Lhs	88	12

Simply Control Trepper
 Profili giunto aperto
 Open joint door
 profile

Frontale lungo
 piatto in inox
 Long flat front plate in
 stainless steel

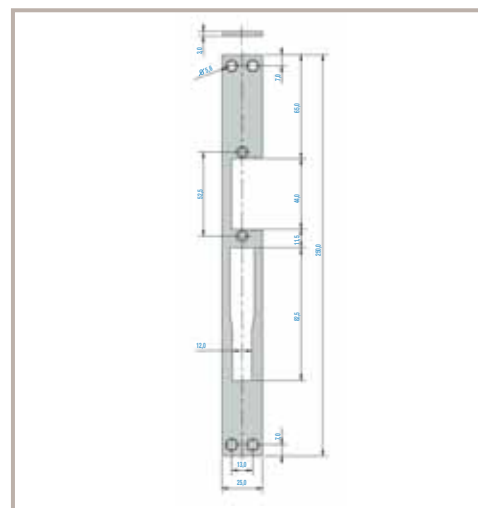

Codice / Code	Mano / Side		
Con vaschetta - With cup			
16178	Reversibile / Reversible	110	12

Frontali

Front plates

Per serrature per porte in legno
For mortise locks for
timber doors

frontale angolare in
acciaio verniciato bronzo
Angular front plate in
painted brown steel



Codice / Code

Mano / Side



Con tappi e vaschetta - With caps and cup

16189/D

Dx / Rhs

178

12

16189/S

Sx / Lhs

178

12

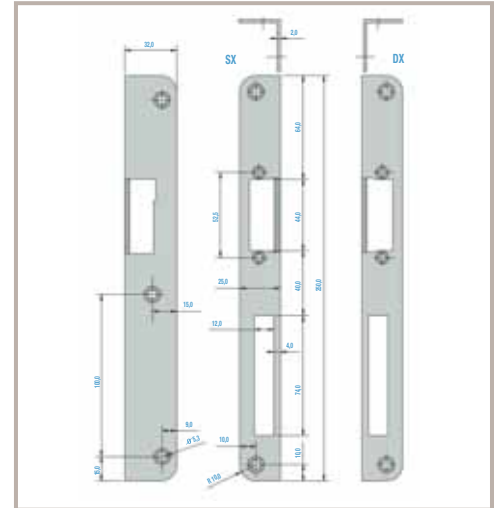

Per serrature per porte in legno
For mortise locks for
timber doors

Frontale lungo
piatto in inox
Long flat front plate in
stainless steel

4 fori di fissaggio
4 fixing holes



Codice / Code

Mano / Side



Con vaschetta - With cup

16190

Reversibile / Reversible

116

12

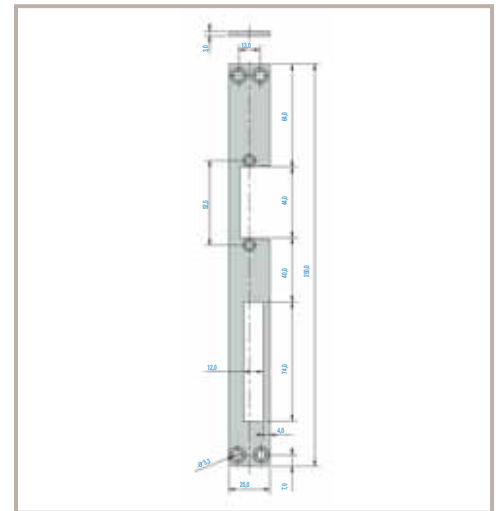

Per serrature per porte in legno
For mortise locks for
timber doors

Frontale lungo
piatto in inox
Long flat front plate in
stainless steel

2 fori di fissaggio
2 fixing holes



Codice / Code

Mano / Side



Con vaschetta - With cup

16193

Reversibile / Reversible

112

12

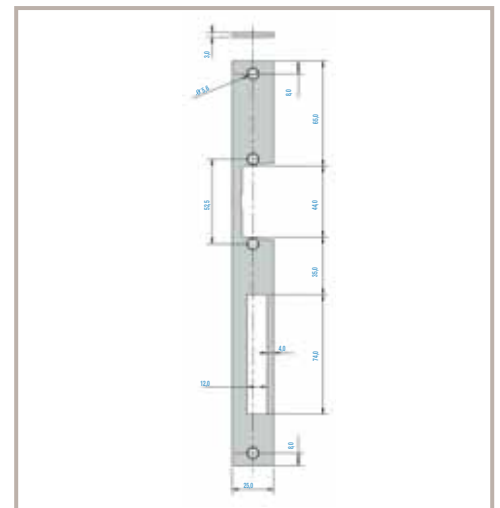

Frontali

Front plates

Per Avant e Miniavant
 Profili porta
 For Avant e Miniavant
 Door profile

Frontale lungo a U
 in inox
 Long U - rail front plate
 in stainless steel



Codice / Code	Mano / Side	gr.	
---------------	-------------	-----	---

Con tappi e vaschetta - With caps and cup

16191/D	Dx / Rhs	86	12
16191/S	Sx / Lhs	86	12

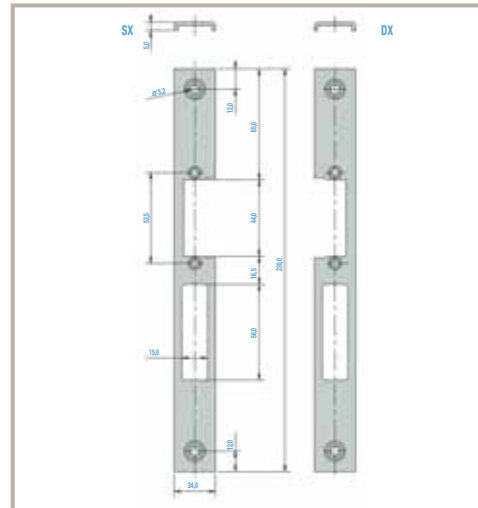

Per Avant e Miniavant
 Profili giunto aperto
 For Avant e Miniavant
 Open joint door profile

Frontale lungo
 piatto in inox
 Long flat front plate in
 stainless steel





Codice / Code	Mano / Side	gr.	
---------------	-------------	-----	---

Con vaschetta - With cup

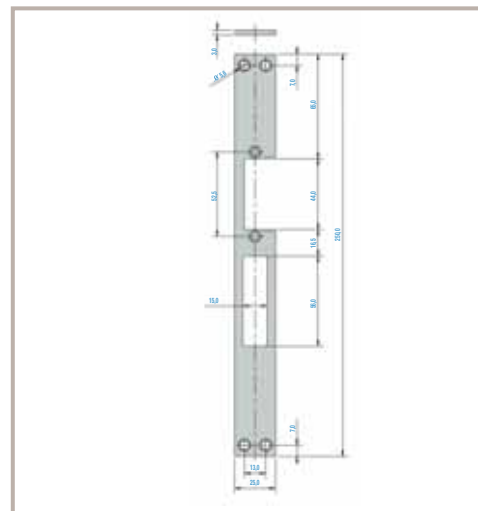

16192	Reversibile / Reversible	118	12
--------------	--------------------------	-----	----



Codice / Code	Finitura / Finish	Serve per: / Use for:		
---------------	-------------------	-----------------------	---	---

Vaschette
Cups

16195/2	Nylon	16184/D 16184/S 16191/D 16191/S	10	1
16196/2	Nylon	16177/D 16177/S	10	1
16195/3	Nylon	16185 16192	10	1
16196/3	Nylon	16178	10	1
16199/3	Nylon	16190	10	1
16199/2	Nylon	16189/D 116192/S	10	1

Codice / Code	Finitura / Finish	Serve per: / Use for:		
---------------	-------------------	-----------------------	---	---

Tappo
Cap

16194	Nylon	Tutti i frontali ad U All U front plates	2	500
-------	-------	---	---	-----



ASSA ABLOY Italia S.p.A.
Via Modena 68 - 40017 San Giovanni in Persiceto (BO) Italy
Tel. +39 051 6812411 - Fax +39 051 827486
info@assaabloy.it - www.assaabloy.it

ASSA ABLOY is the global leader in door opening solutions, dedicated to satisfying end-user needs for security, safety and convenience.

www.assaabloy.com



ASSA ABLOY Italia S.p.A. si riserva di apportare in qualunque momento e senza preavviso le modifiche necessarie per migliorare ed evolvere le caratteristiche dei propri prodotti. Fotografie, illustrazioni e descrizioni sono da ritenersi indicative.
ASSA ABLOY Italia S.p.A. reserves the right at any time, and without notice, the necessary modifications in order to improve and evolve the characteristics of their products. Photographs, illustrations and descriptions ought to be considered as indicative.

H001801 | 01-2008